

ZON QUARTZ CLOCK TIMER

1001 - INSTRUCTION MANUAL

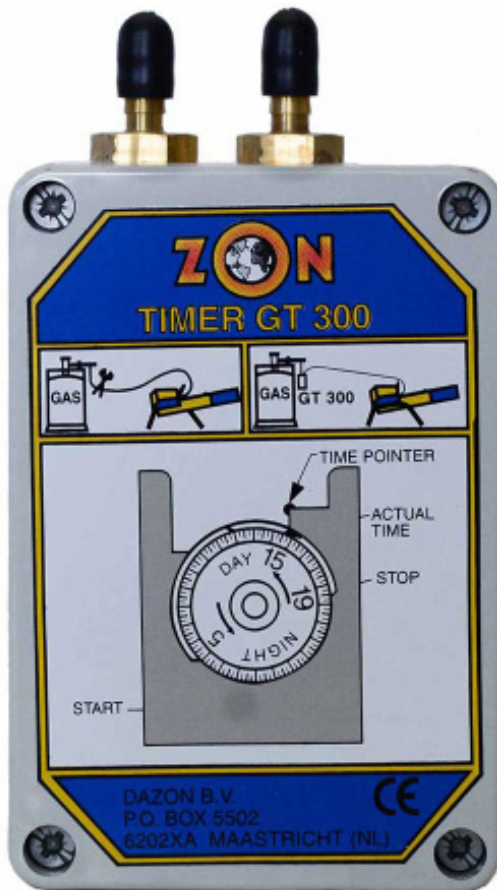

FOR PRODUCT
MANUALS AND VIDEOS,
SCAN THE QR CODE



Paired with the Zon Mark IV Scare Cannon, the Zon Quartz Clock Timer (#1001) controls gas flow which causes the cannon to activate and deactivate at a desired time. The Zon Quartz Clock Timer is powered by a AA battery.

PARTS DIAGRAM

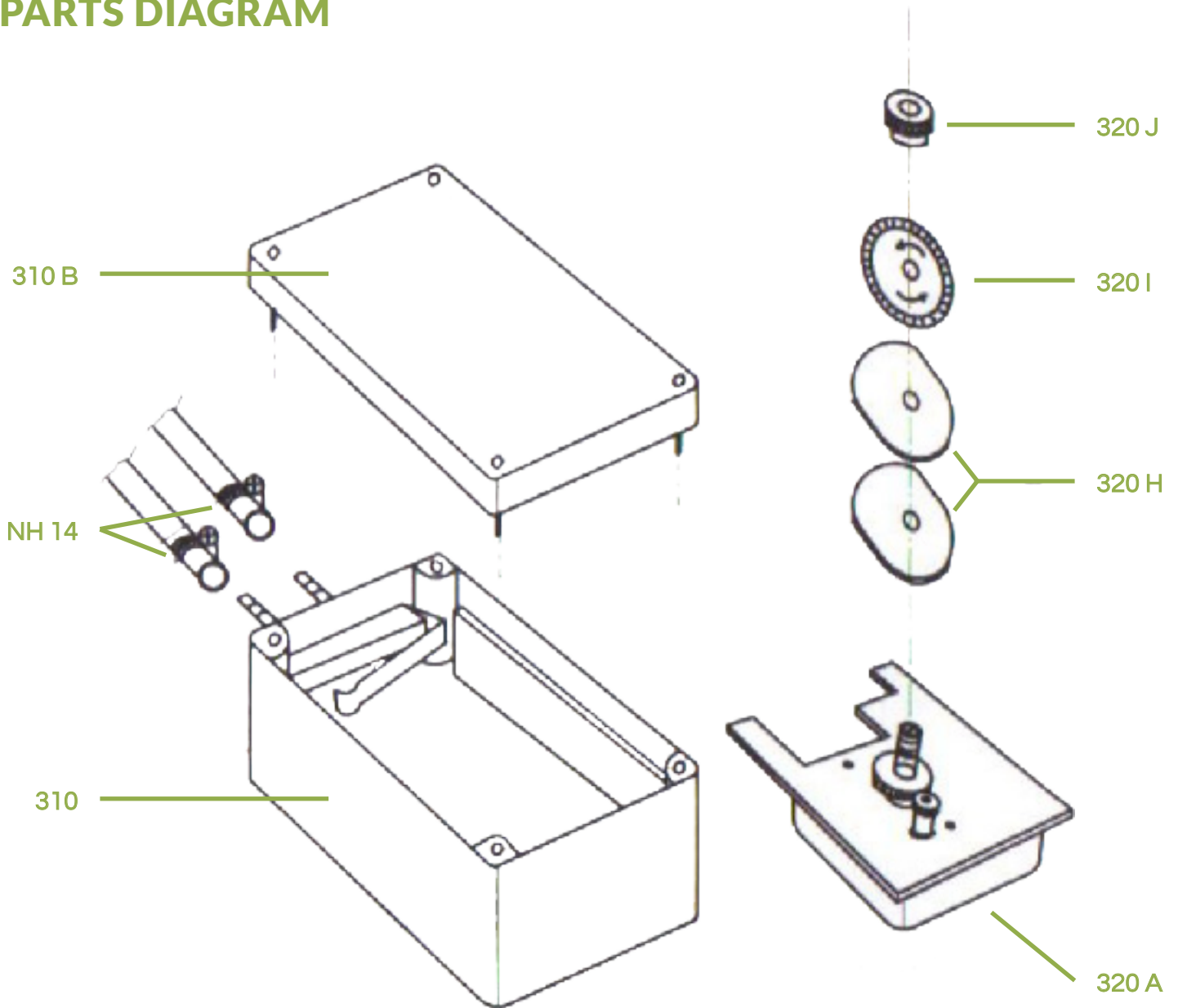

PARTS LIST

310	Case with Gas Valve	320 I	Dial
310 B	Lid	320 J	Milled Nut
320 A	Drive Unit	NH 14	Adjustable Clamp
320H	Regulating Disc		

SAFETY

- ▶ To prevent gas leakage it is strictly prohibited to dismantle parts of the timer.
- ▶ The timer cannot be used at temperatures below -10°C (14°F).
- ▶ Avoid rough handling, especially shocks and bumps.
- ▶ Keep the gas hose and nipples free of dust etc. Dust can cause leakage.

- ▶ Only for outside use.
- ▶ Wear ear protection when operating the scare cannon.



INSTALLATION

Note:

Make sure to close the valve of the gas bottle when fitting the timer.

1. Cut the hose between the propane tank and the scare cannon at a distance of approximately 10-15cm. Remove the caps from the nipples of the timer.
2. Slide the Hose Clamps (#NH 14) over the hose and fit the hose on the nipples. The hose coming from the propane tank has to be fitted on the left nipple (marked "in") and the hose coming from the scare cannon has to be fitted to the right nipple (marked "out"). Tighten both clamps with a screw driver.



3. Make sure the gas regulator is connected to the propane tank in such a way that the nipple of the interval regulator points downwards. Doing this will ensure that the timer is secured in a vertical position.

SETTING TIME

1. Remove the Lid (#310 B) from the timer.

2. Remove the Drive Unit (#320 A) from the timer and insert a battery type AA-R6 1.5V.

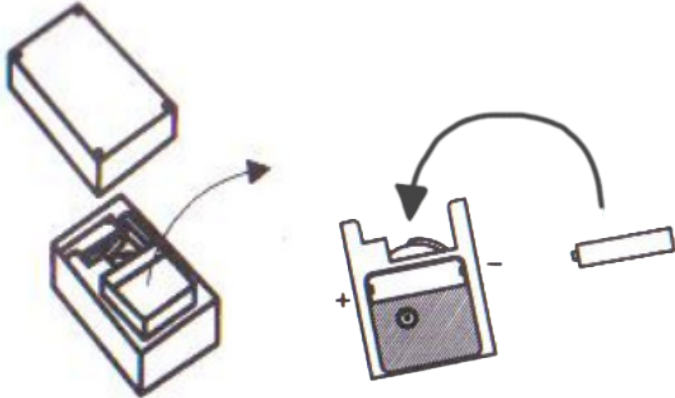

3. Turn the Drive Unit (#320 A) so the Dial (#320 I) becomes visible.

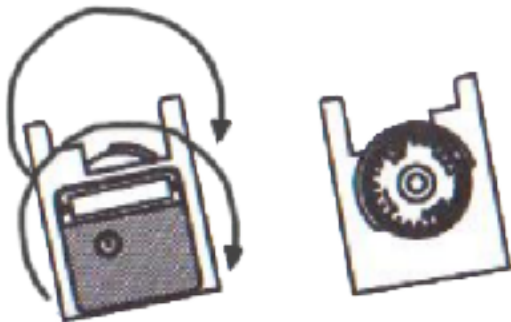

4. The dial revolves once per 24 hours counter-clockwise and is divided by day and night time.

5. To set the time remove the Milled Nut (#320 J) while holding the Dial (#320 I).



Never hold the Milled Nut (#320 J) while holding the Drive Unit (#320 A). This could cause damage to the Drive Unit.



6. Turn the Dial (#320 I) in such a way that the actual time corresponds with the time pointer.

7. Turn the starting point of the lower Regulating Disc (#320 H) to the required starting time (start) and turn the end point of the other Regulating Disc (#320 H) to the required closing time (stop).

Example:

Your watch shows 3 pm (actual time) and you want to operate the scare cannon between 5 am and 7 pm.

- The time pointer points to the digit 15 on the dial (3 pm)
- The starting point of the lower regulating disc points at the digit 5 (start) of the dial
- The end point of the upper regulating disc (stop) points to the digit 19 (7 pm)

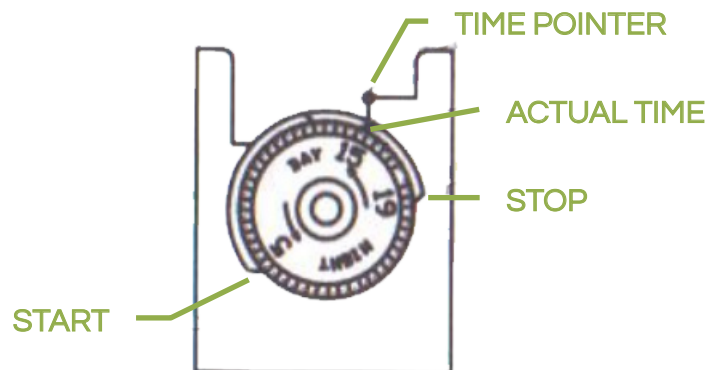

SETTING TIME

8. After setting the times, tighten the Milled Nut (#320 J) while holding the Dial (#320 I) with two fingers.



9. Turn the Drive Unit (#320 A) and insert it back in the housing while slightly tilting it. Be sure that the Regulating Discs (#320 H) are opposite to the lever of the gas valve.

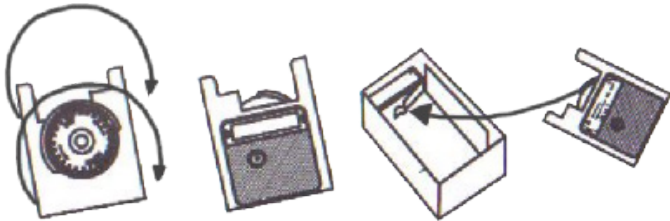

10. Put the Lid (#310 B) on the timer. For good rain protection, it is necessary that the four screws are tightened in such a way that the Lid and housing are tight to each other and no space is visible.

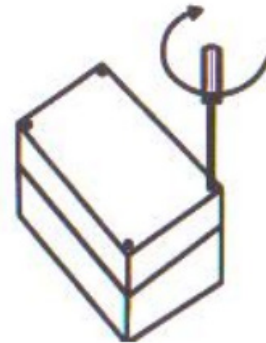

11. Open the main valve on the propane tank.

12. The timer will operate now automatically.

GENERAL

- ▶ The Dial (#320 I) turns to the left (counter-clockwise).
- ▶ The elevated part of the Regulating Disc (#320 H) opens the gas valve through the lever. This will start operating the scare cannon.
- ▶ When the Regulating Disc (#320 H) is low, there should be a space of 1-1.5 mm between the lever and the regulating disc. The proper function of the gas valve can be checked by pushing against the lever. Afterwards the lever should drop because of the spring pressure inside the gas valve.
- ▶ At the beginning of a new season a new battery should be inserted.
- ▶ This timer can be connected to any scare cannon device operating on L.P. gas. The timer enables you to start and stop the scare cannon at any hour you wish.
- ▶ The timer is capable to make one switch a day, on and off (minimum 10 hours, maximum 18 hours) during a period of several months.